



THIS PACK CONTAINS:

- STANDARD GLAZING BAR
- STANDARD HIP GLAZING BAR
- STANDARD WALL GLAZING BAR
- STANDARD RIDGE BAR

LENGTH:

- 2.5m
- 3m
- 4m
- 6m

OTHER PRODUCTS AVAILABLE

Self Supporting Roof Materials:- span up to 5m on a lean-to, 6m over a ridge without a supporting structure.

PVCu Roof Vents:- White, Brown, High White and Golden Oak vents with Brass/Chrome or electric openers for Polycarbonate and Glass roofs. Made to Measure vents are available in the full colour range with a choice of openers.

Standard and Bespoke Kit Roofs:- when bought in kit form, most domestic sizes can be assembled on frames in under an hour! No special tools required.

Rafter Glazing System:- screw down aluminium capping for use with timber roofs.

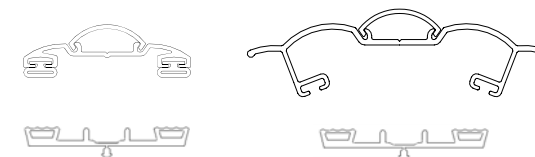

The manufacturer reserves the right to alter the specifications of any product without prior notice. The manufacturer cannot accept any claims or responsibility for product misused, mishandled, incorrectly assembled or not installed in accordance with both the sheet manufacturer's and its own recommendations. © All products and drawings are the copyright of Newdawn & Sun Limited.

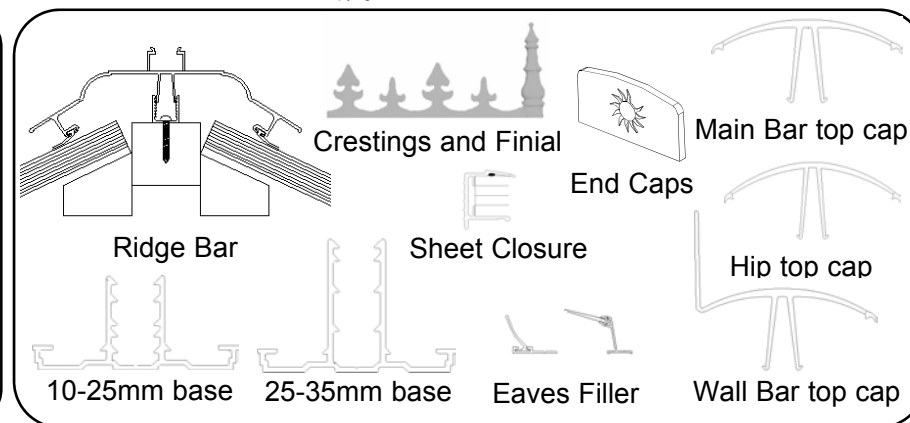
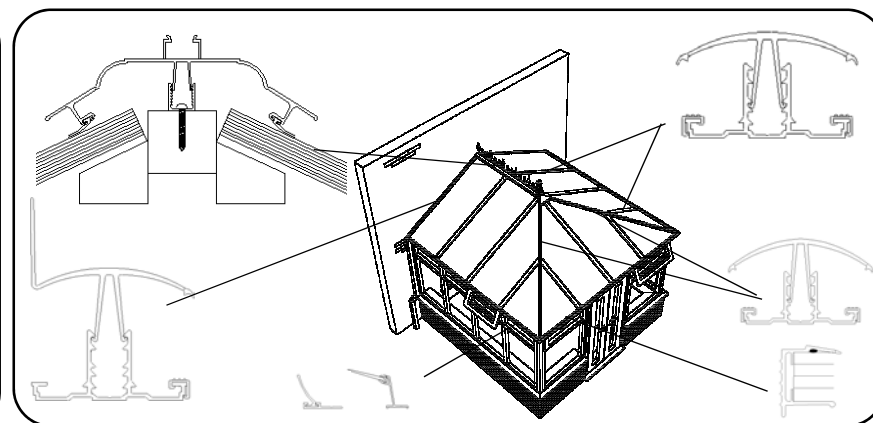
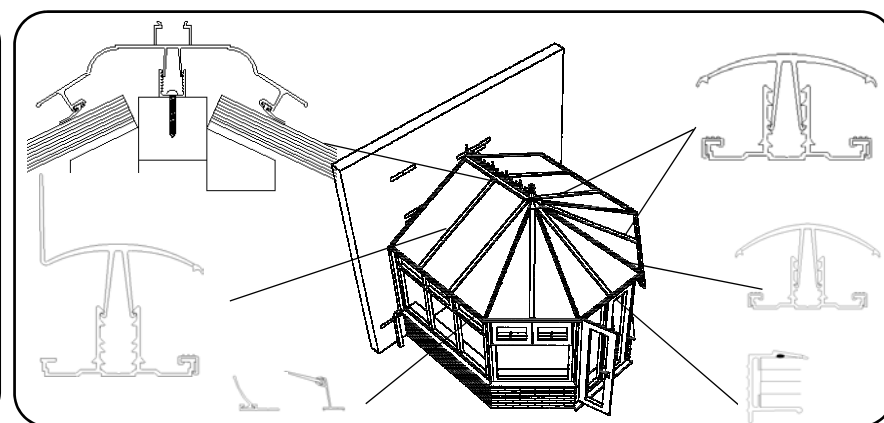
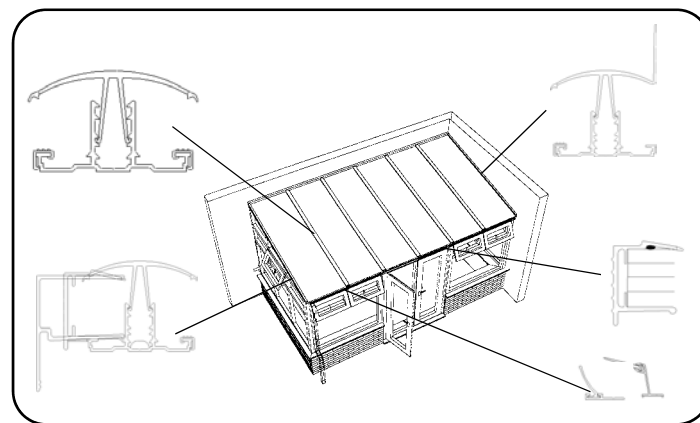

1

To fit metal end clip, screw tag into the channel of the bar. Push the end cap into position

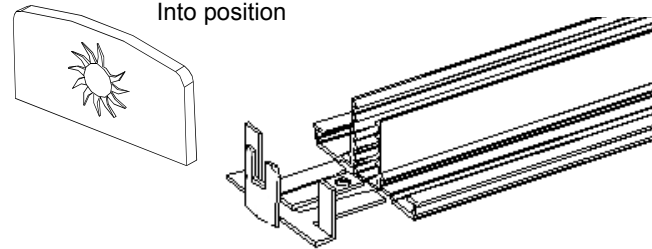

Screw bars to timber 100mm from each end and at equal intervals of 375mm.

2

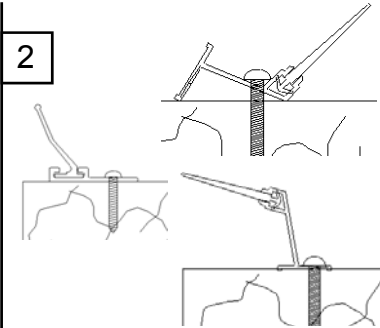

Fit eaves filler between glazing bars as required.

3

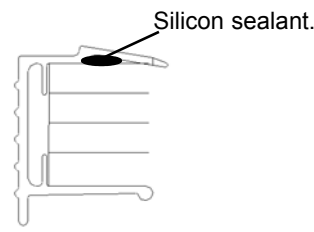

Fit sheet closure to polycarbonate or glass running a thin line of silicon sealant along the top inside face of the sheet closure.

4

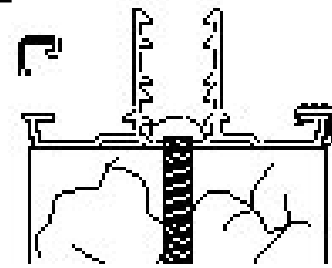

Fit gaskets to bars.

5

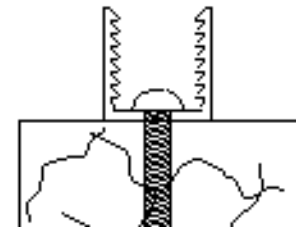

Screw Ridge base to timber.

6

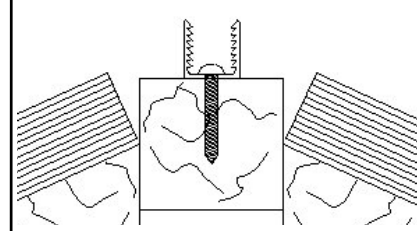

Fit glazing bars along side of ridge (see above instructions).

7

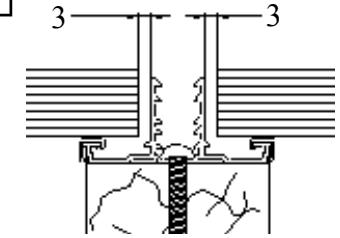

Put glazing material in place allowing for expansion:- 3mm per metre width and 3mm per metre length (at top end).

8

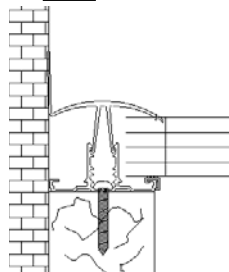

Use the wall bar top cap when against a wall.

9

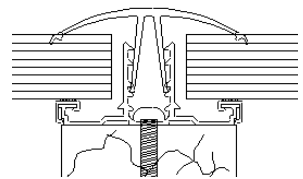

Use sheet closure or F section to finish the edge bar.
Place the pvc cap over the aluminium base and press into position. This is best done by tapping gently with a mallet, protecting the pvc cap with a piece of wood. Trim back the internal legs at the top by approx 20mm. To allow the top cap to sit over the ridge flipper.

10

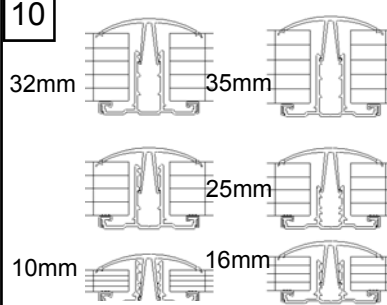

Ensure the Top Cap is pushed to correct position

11

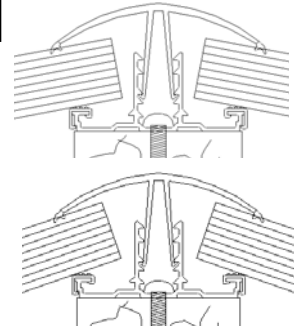

Use Hip Top Cap for Victorian and Edwardian Hips.

12

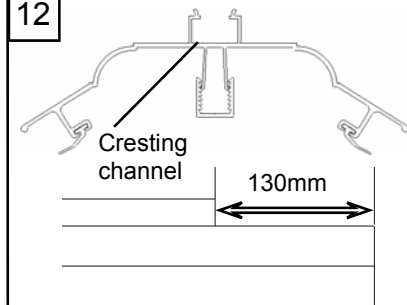

Remove creasting channel at both ends of ridge to allow for spider capping and water drainage.

13

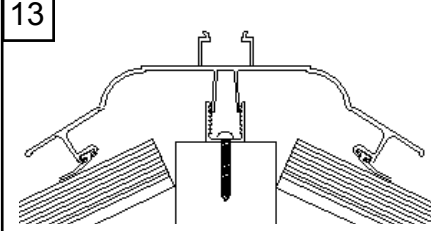

Place the ridge cap over the aluminium base and press into position. This is best done by tapping gently with a mallet, protecting the cap with a piece of wood.

14

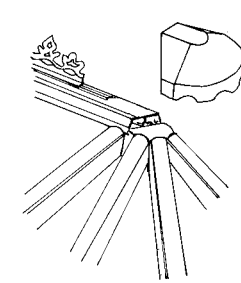

Slide creasting into creasting channel on top of ridge cap. Carefully cut the spider top cap to fit over the hip bars.

15

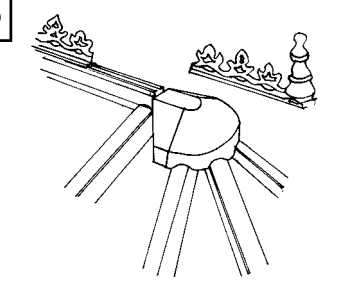

Position spider cap over end of ridge and slide creasting and finial into creasting channel to hold down spider cap.